



# RACK CONVEYOR DISHWASHER SRC-1800

67/100 baskets per hour (up to 1.800 plates/hour)



WARE WASHING  
RACK CONVEYOR DISHWASHERS



## SALES DESCRIPTION

Compact model for reduced space areas.  
2 speed.

## FEATURES AND BENEFITS

- ✓ Fully stainless steel jacket.
- ✓ Stainless steel central rack feed system.
- ✓ Process cycles are divided by rubber curtains.
- ✓ Automatic cycle start.

### Economy

- ✓ Energy saving rinse supply switch.
- ✓ Pressure controller in the rinse section to limit consumption.
- ✓ Programmed automatic stops if there is no loading.
- ✓ Stop and freezing of timer when the limit switch actuates.

### Cleaning and maintenance

- ✓ Wide pivoting door allowing access for cleaning or inspection purpose.
- ✓ Detachable arms and dispersers for easier cleaning.
- ✓ Sloped removable stainless steel filters.
- ✓ Easy boiler emptying by loosening a hose.
- ✓ Failures are easily detected thanks to the warning lights.
- ✓ Easy to repair without moving the machine.

### Washing

- ✓ Stainless steel wash arms and deep-drawn dispersers.
- ✓ Efficient and durable wash arm dispersers.
- ✓ Powerful, self-draining vertical wash pump.
- ✓ Easy to install detergent dosifier intake in washing tank.

### Rinsing

- ✓ Stainless steel rinse arms and powerful, stainless steel, deep-drawn dispersers.
- ✓ Automatic boiler filling with no failure risk for heating elements.
- ✓ Temperature control with high precision probes.
- ✓ Visualisation and adjustment of washing and rinsing temperatures in the digital display by pressing a button.
- ✓ Easy to install rinse aid dispenser intake in boiler.



**www.sammic.co.uk**  
 Food Service Equipment Manufacturer  
 Unit 2, Trevanth Road  
 Troon Industrial Park  
 LE4 9LS - Leicester  
 uksales@sammic.com  
 Tel.: +44 0116 246 1900



Project	Date
Item	Qty
Approved	

product sheet  
updated 06/03/2018



# RACK CONVEYOR DISHWASHER SRC-1800

67/100 baskets per hour (up to 1.800 plates/hour)



WARE WASHING  
RACK CONVEYOR DISHWASHERS

## SPECIFICATIONS

### Production

- ✓ Production baskets/hour: 100
- ✓ Production plates/hour: 1800

### Wash

- ✓ Temperature: 55 °C - 65 °C
- ✓ Wash tank capacity: 80 l
- ✓ Pump: 2 Hp / 1500 W
- ✓ Wash heating element: 7500 W

### Rinse

- ✓ Temperature: 80 °C - 90 °C
- ✓ Water consumption: 270 l/h
- ✓ Rinse heating element: 18000 W
- ✓ Boiler capacity: 20 l

### Drag

- ✓ Drag motor power: 0.25 Hp / 135 W

### Loading

- ✓ Central module total power : 27135 W

### External dimensions (WxDxH)

- ✓ Width: 1180 mm
- ✓ Depth: 829 mm
- ✓ Height: 1430 mm

**Net weight:** 200 Kg

**Water Intake:** 3/4 "

**Drain diameter:** 1 1/2 "

**Noise level (1m.):** 71 dB(A)

### Optional accessories

- ✓ Drying unit: TS-600
- ✓ Extraction systems: CA/EV/CV
- ✓ Tables

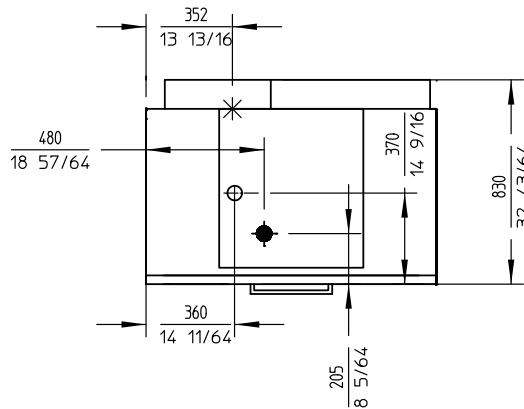
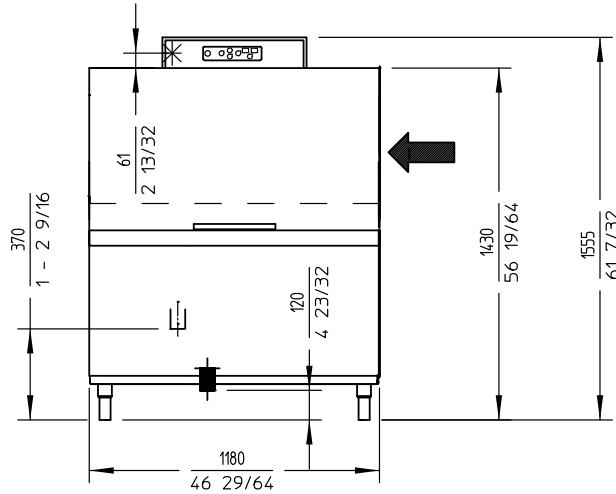

## AVAILABLE MODELS

1302400 Dishwasher SRC-1800D 400/50/3N (right hand entry)

1302419 Dishwasher SRC-1800I 400/50/3N (left hand entry)

\* Ask for special versions availability

## ACCESSORIES

- Drying units
- Manual water softeners
- Automatic water softeners
- 500 x 500 mm. baskets
- Inserts, supplements & similar
- Loading table for corner situation for rack conveyor dishwashers
- Central sorting tables
- Single exit tables
- Roller conveyor and corner roller conveyor
- Machined curve
- EV Extraction hood with motor
- CV Extraction hood with steam condensation
- Drying unit for corner situation



[www.sammic.co.uk](http://www.sammic.co.uk)

Food Service Equipment Manufacturer

Unit 2, Trevanah Road  
Troon Industrial Park  
LE4 9LS - Leicester

uksales@sammic.com  
Tel.: +44 0116 246 1900



Project

Date

Item

Qty

Approved

product sheet  
updated 06/03/2018